

# AIR23(esploso)

## FOTO N° 1

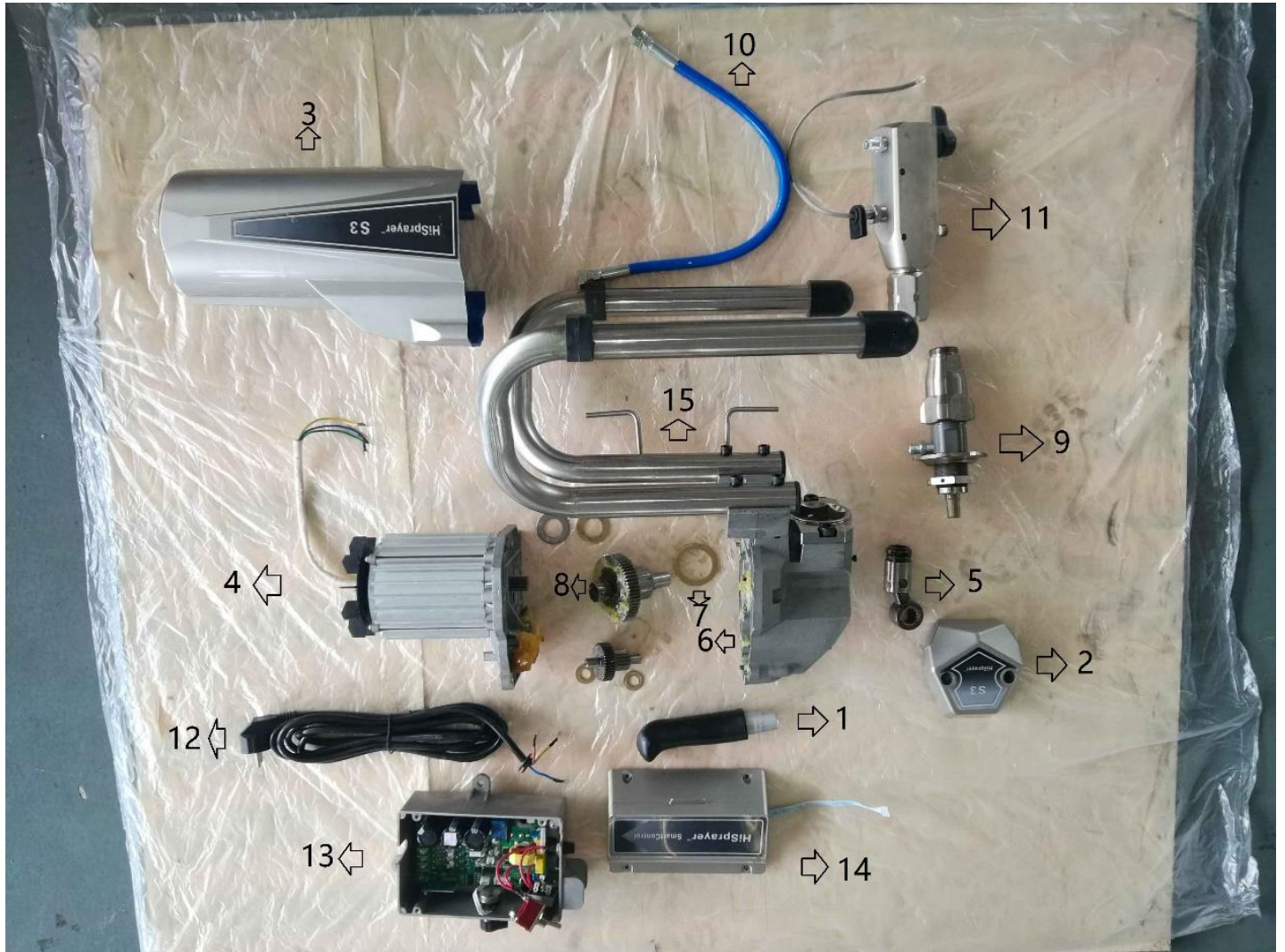

	Part No.	Description		ART. FIXLINE
1	101	handle		<b>RAIR23-F1-1</b>
2	102	Front cover		<b>RAIR23-F1-2</b>
3	103	Motor box		<b>RAIR23-F1-3</b>
4	23104	Motor		<b>RAIR23-F1-4</b>
5	105	Connecting rod		<b>RAIR23-F1-5</b>
6	106	housing		<b>RAIR23-F1-6</b>
7	107	washer		<b>RAIR23-F1-7</b>
8	108	Gear		<b>RAIR23-F1-8</b>
9	109	Pump assembly		<b>RAIR23-F1-9</b>
10	110	hose		<b>RAIR23-F1-10</b>
11	111	Manifold assembly (no inculd transducer)		<b>RAIR23-F1-11</b>
12	112	Power wire		<b>RAIR23-F1-12</b>
13	23113	Control board with filter		<b>RAIR23-F1-13</b>
14	114	Control board cover		<b>RAIR23-F1-14</b>
15	115	Rack assembly		<b>RAIR23-F1-15</b>

**FOTO N° 2**



				<b>ART. FIXLINE</b>
118	Hose suction kit			<b>RAIR23-F2-1</b>
119	suction filter			<b>RAIR23-F2-2</b>

## FOTO N° 3

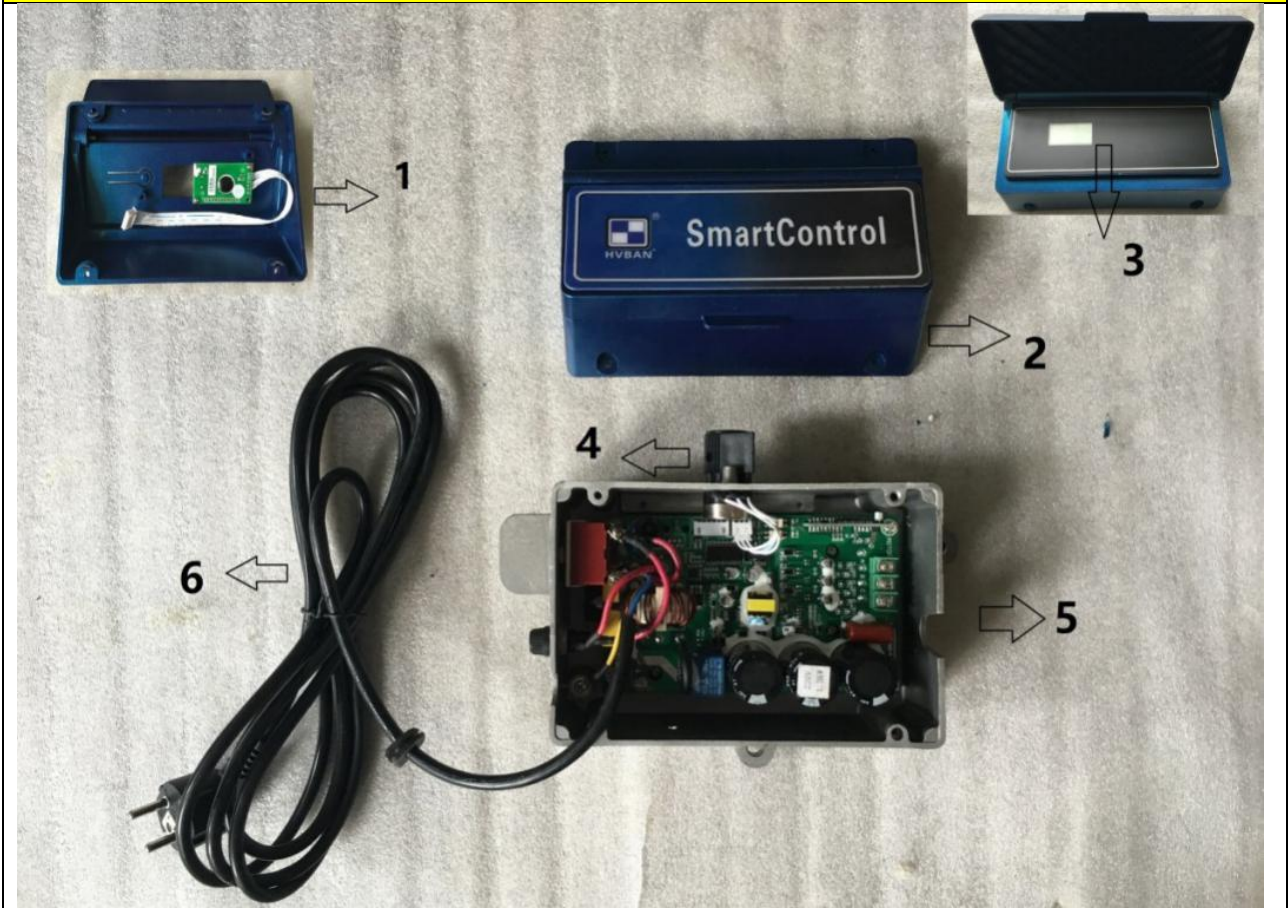

					<b>ART. FIXLINE</b>
1 3	116	LED display			<b>RAIR23-F3-1</b>
2	114	Control broad cover			<b>RAIR23-F3-2</b>
4	117	Pressure control knob			<b>RAIR23-F3-4</b>
5	23113	Control board			<b>RAIR23-F3-5</b>
6	112	Power wire			<b>RAIR23-F3-6</b>

**FOTO N° 4**

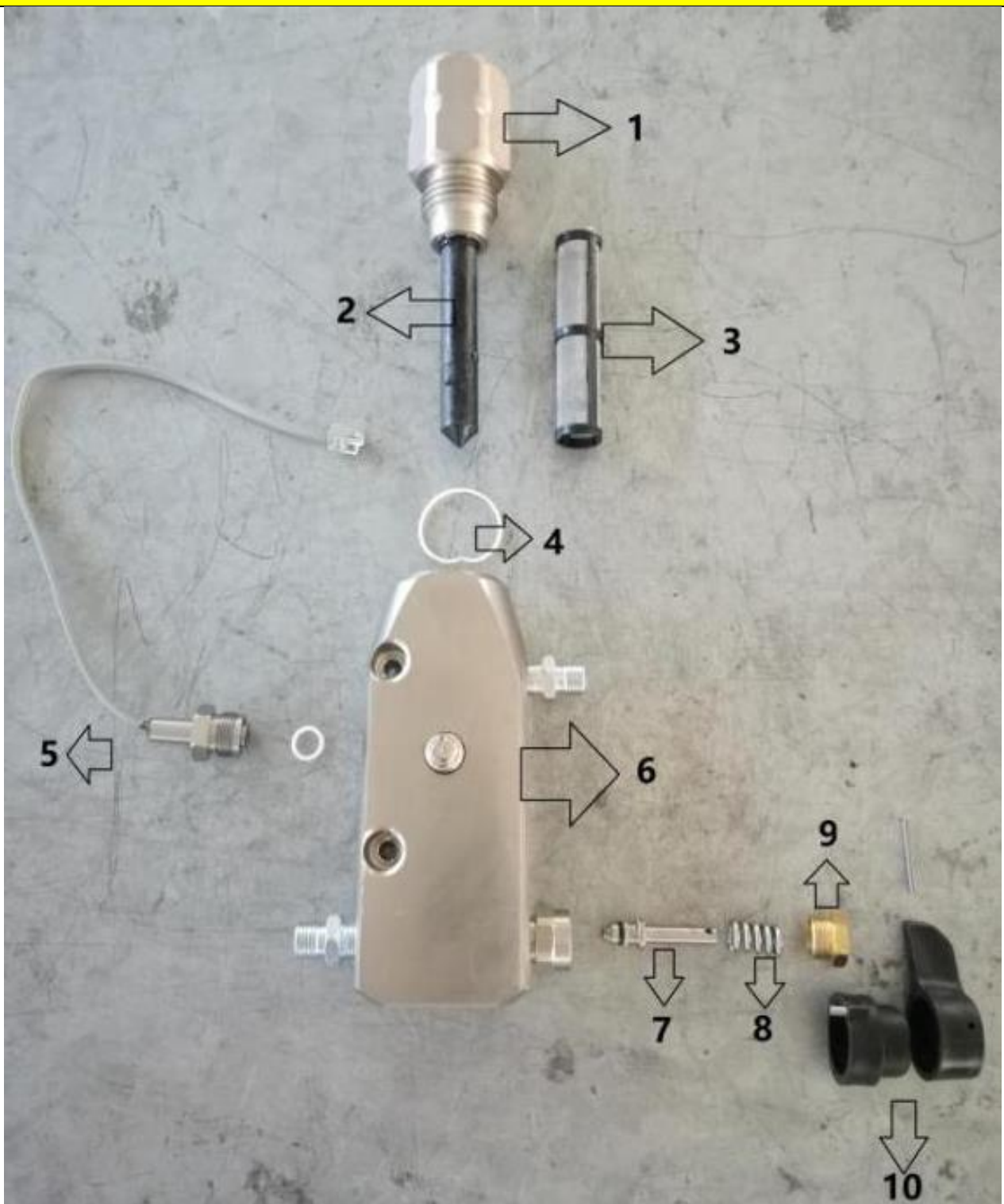

	Part No.	description		ART. FIXLINE
1	11101	manifold cap		RAIR23-F4-1
2	11102	Filter core		RAIR23-F4-2
3	11103	filter		RAIR23-F4-3
4	11104	o-ring		RAIR23-F4-4
5	11105	transducer		RAIR23-F4-5
6	11106	manifold		RAIR23-F4-6
7 8 9 10	11107	Prime valve with knob		RAIR23-F4-7

## FOTO N° 5

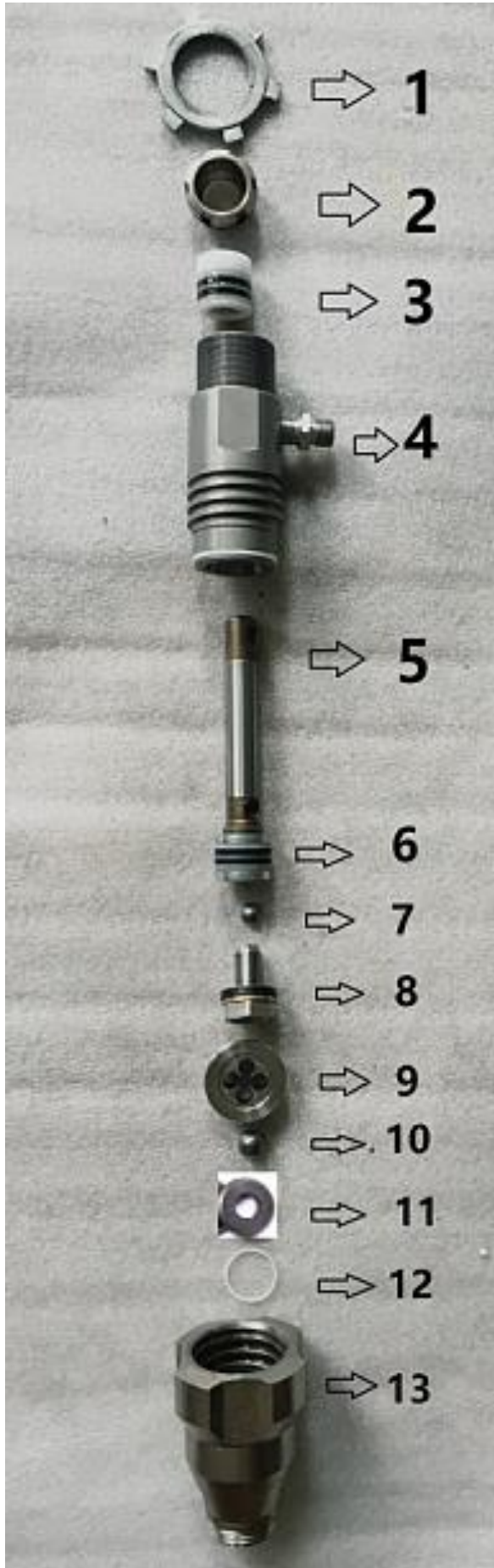

	Part No.	description		ART. FIXLINE
1	311091	nut		RAIR23-F5-1
2	311092	gland		RAIR23-F5-2
3/ 6/ 7/ 10/ 12	311093	repair kit		H-HB29002
4	311094	Cylinder (steel)		RAIR23-F5-4
5	311095	Piston rod		RAIR23-F5-5
8	311096	Piston valve		RAIR23-F5-8
9	311097	Ball guide		RAIR23-F5-9
11	311098	ball seat (steel)		RAIR23-F5-11
13	311099	Intake housing		RAIR23-F5-13
1- 13	311100	Pump assembly		RAIR23-F5-1-13
1- 13	311100	Pro-connect Pump assembly		